

Soils Map

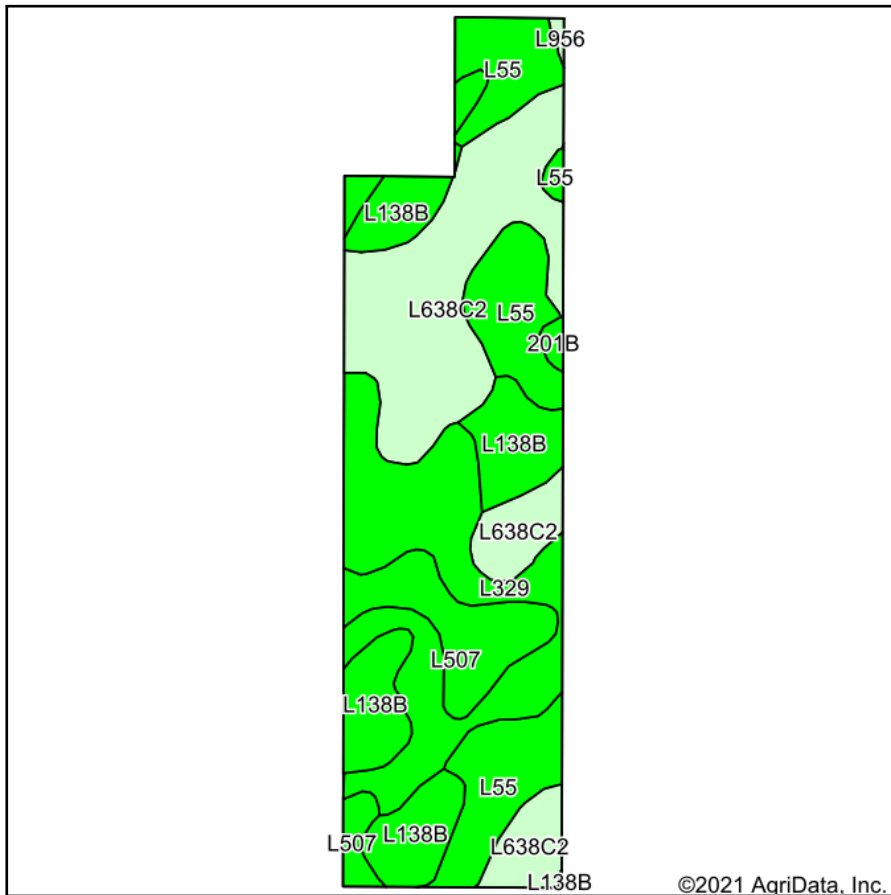

Soils data provided by USDA and NRCS.

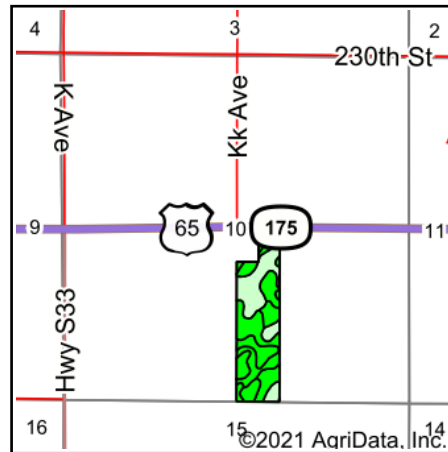

State: **Iowa**
 County: **Hardin**
 Location: **10-87N-21W**
 Township: **Tipton**
 Acres: **35.5**
 Date: **10/10/2021**



Area Symbol: IA083, Soil Area Version: 27

Code	Soil Description	Acres	Percent of field	CSR2 Legend	Non-Irr Class *c	CSR2**	CSR	
L638C2	Clarion-Storden complex, Bemis moraine, 6 to 10 percent slopes, moderately eroded	10.45	29.4%		IIIe	75		
L329	Webster-Nicollet complex, Bemis moraine, 0 to 3 percent slopes	7.89	22.2%		IIw	89		
L55	Nicollet loam, 1 to 3 percent slopes	7.25	20.4%		Ie	91		
L138B	Clarion loam, Bemis moraine, 2 to 6 percent slopes	6.23	17.5%		IIe	88		
L507	Canisteo clay loam, Bemis moraine, 0 to 2 percent slopes	3.41	9.6%		IIw	87		
201B	Coland-Terril complex, 2 to 5 percent slopes	0.19	0.5%		IIw	80	69	
L956	Harps-Okoboji complex, Bemis moraine, 0 to 2 percent slopes	0.08	0.2%		IIw	69		
Weighted Average						2.09	84.8	*-

**IA has updated the CSR values for each county to CSR2.

*- CSR weighted average cannot be calculated on the current soils data, use prior data version for csr values.

*c: Using Capabilities Class Dominant Condition Aggregation Method

Soils data provided by USDA and NRCS.