

# Soils Map

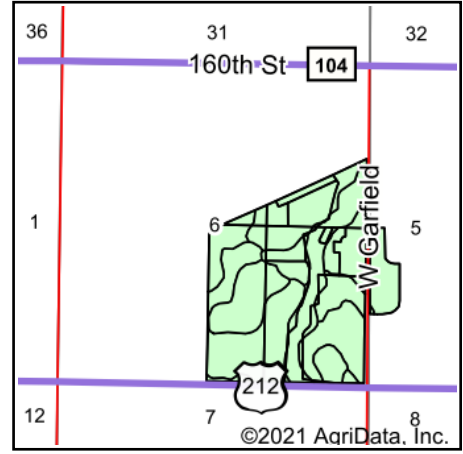
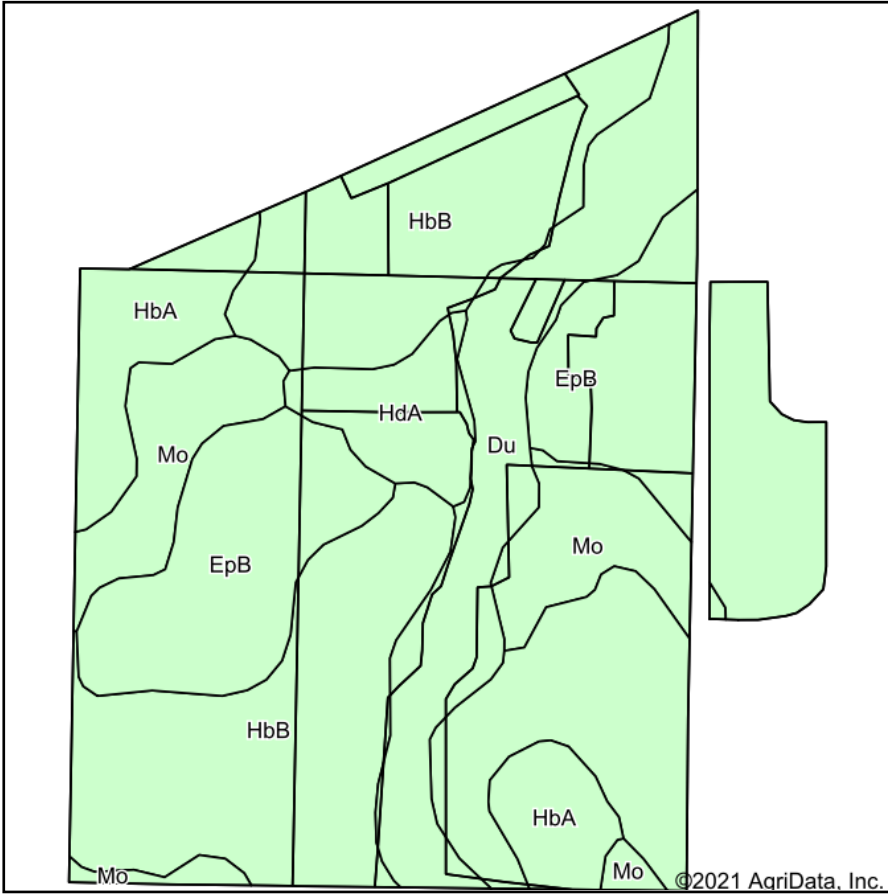

State: **South Dakota**  
 County: **Potter**  
 Location: **6-118N-74W**  
 Township: **East Potter**  
 Acres: **197.33**  
 Date: **6/30/2021**

**ADVANTAGE**  
*Land Co.*

Maps Provided By:  
  
 CUSTOMIZED ONLINE MAPPING  
 © AgriData, Inc. 2021      www.AgriDataInc.com



Soils data provided by USDA and NRCS.

Area Symbol: SD107, Soil Area Version: 24					
Code	Soil Description	Acres	Percent of field	Non-Irr Class *c	Productivity Index
EpB	Eakin-Peno complex, 2 to 6 percent slopes	66.57	33.7%	Ile	73
HbB	Highmore silt loam, 2 to 6 percent slopes	59.59	30.2%	Ile	91
Du	Durrstein silt loam	26.26	13.3%	Vls	8
Mo	Mobridge silt loam, 0 to 2 percent slopes	20.89	10.6%	Ilc	94
HbA	Highmore silt loam, 0 to 2 percent slopes	16.05	8.1%	Ilc	92
HdA	Highmore-DeGrey silt loams, 0 to 2 percent slopes	7.97	4.0%	Ilc	76
<b>Weighted Average</b>					<b>73.7</b>

\*c: Using Capabilities Class Dominant Condition Aggregation Method  
 Soils data provided by USDA and NRCS.